

acerpure

acerpure cool Series

Air Circulator and Purifier

User Manual

คู่มือผู้ใช้

使用説明書

Model: AC333-10W

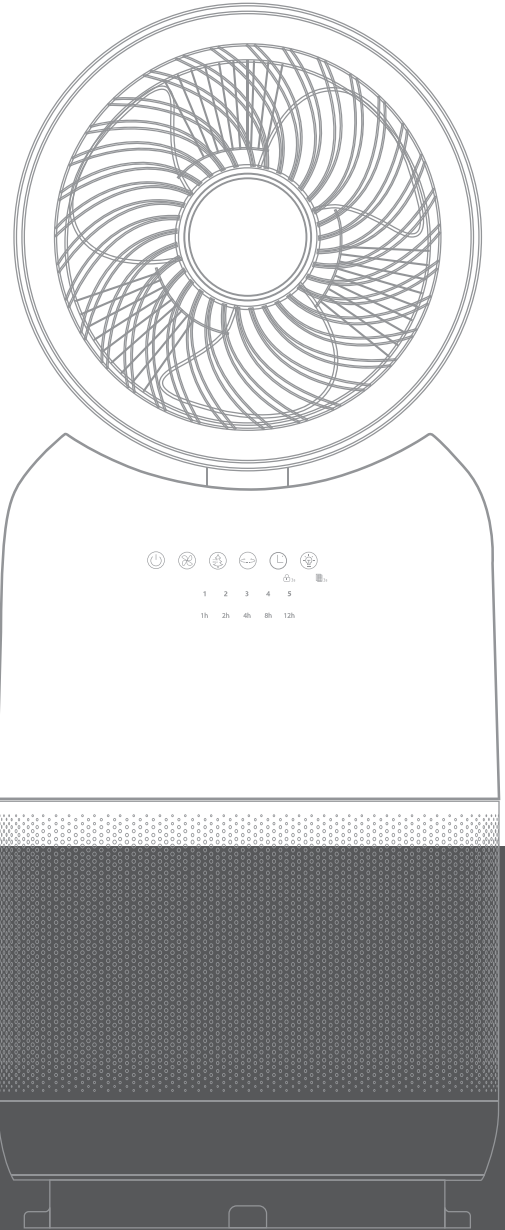

www.acerpure.com

Copyright © 2023 Acerpure Inc. All Rights Reserved.

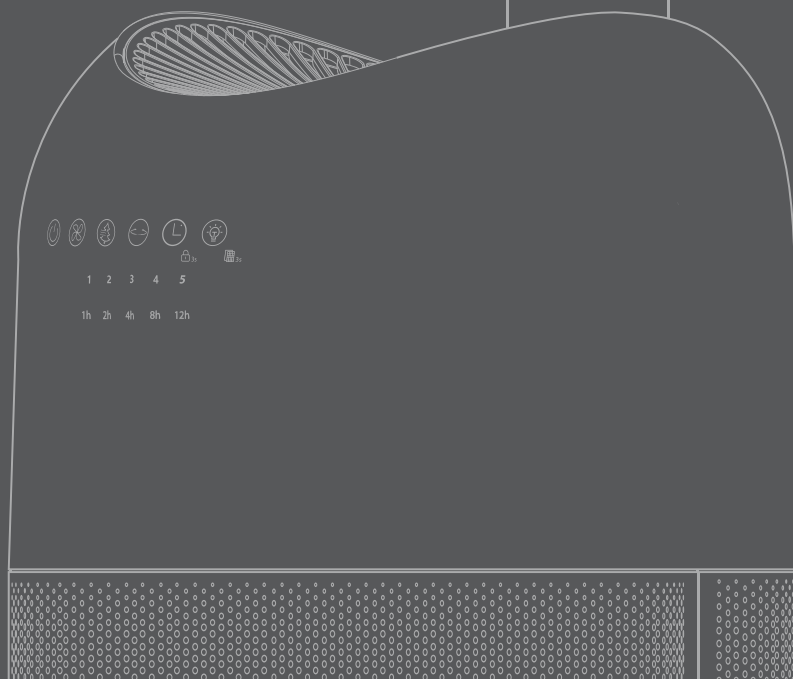
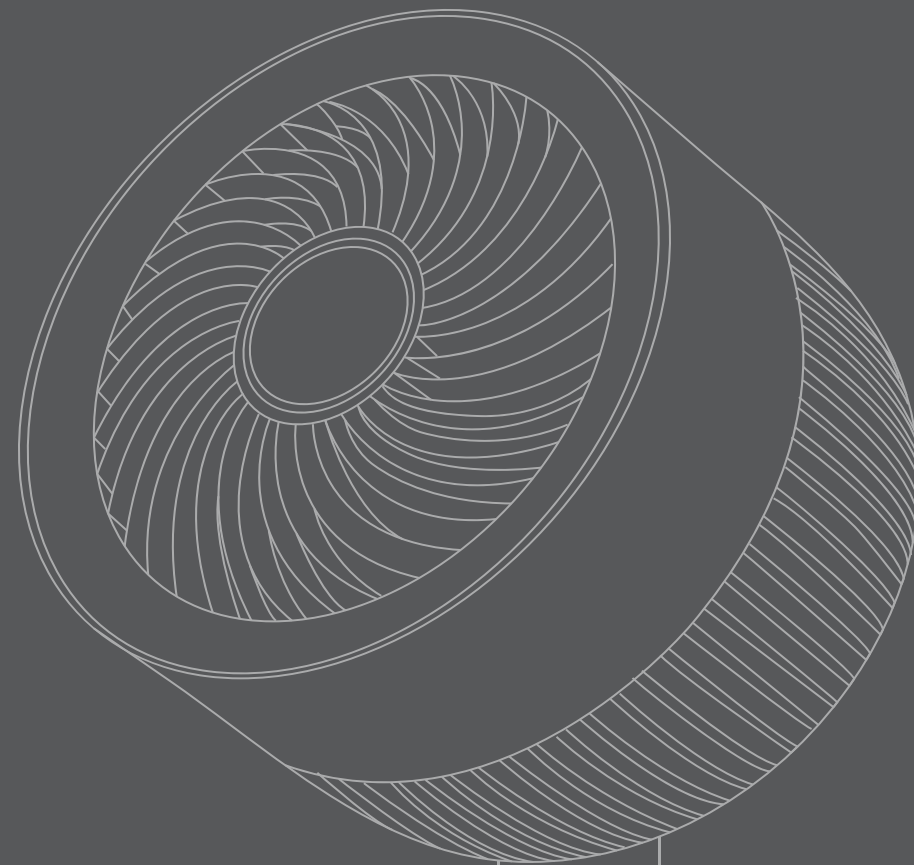

User Manual

Thank you very much for purchasing this product. Please make sure to read this manual carefully, use this product correctly, and store it properly.

Table of Contents

Safety Instructions	05
Introduction to the Accessories	06
Product Structure	07
Function Buttons of the Product	08
Disassembling and Maintenance	09
Battery Precautions	10
Before Seeking After-sales Service	11
Product Specifications and Company Information	12

Safety Instructions



<p>This product is for home and office use. Do not use it for other purposes.</p> <p>! The 2-in-1 Air Circulator and Purifier shall be used for temperate climates and tropical climates.</p>	<p>Before using, check the power cord and plug for damage.</p> <p>! To avoid poor contact, do not twist or pull the power cord.</p>
<p>! Before using, please check if the voltage on your power socket is compatible with the voltage label on the product.</p>	<p>Turn off the power before pulling out the plug.</p> <p>! Do not touch the power plug with wet hands to avoid the risk of electric shock.</p>
<p>⊘ Do not use this product where foreign objects, such as curtains, may be sucked into the air circulator in order to prevent product damages.</p>	<p>⊘ Use of this product without proper assembly is strictly prohibited; it is also prohibited to insert your hand or sharp objects into the guard of the air circulator in order to prevent accidents from occurring. Children should be supervised to ensure they do not play with electrical appliances.</p>
<p>⊘ Do not hang clothes on the guard of the air circulator, and do not use the air circulator at places with barriers or unstable places.</p>	<p>⊘ This appliance can be used by children aged from 8 years and above and persons with reduced physical, sensory or mental capabilities or lack of experience and knowledge if they have been given supervision or instruction concerning use of the appliance in a safe way and understand the hazards involved. Children shall not play with the appliance. Cleaning and user maintenance shall not be made by children without supervision.</p>
<p>⊘ Do not spray liquids such as volatile agents or insecticides on this product.</p>	<p>⊘ Do not use this product at places with high temperature (over 40°C), high humidity (such as bathrooms), dusty or where acid-base oils can easily spill.</p>
<p>! If you do not use the product for long periods of time, please unplug the power plug, especially when there is inclement weather such as thunderstorms, lightning, and other hazards. Please turn off the power immediately and pull out the plug.</p>	<p>! This product only requires external cleaning and maintenance; do not clean the surface with rough cleaning tools, and do not rinse it with water directly.</p>
<p>! If the product was accidentally immersed in water, please stop using it immediately and contact customer service.</p>	<p>! If the product is operating abnormally, such as giving off noise, smoke, or odors, please turn off the power immediately, unplug the product, and contact customer service.</p>
<p>! If the power cord is damaged, it must be replaced by the manufacturer, its service agent or similarly qualified persons in order to avoid a hazard.</p>	<p>! For customer service contact information, please see the company information at the end of this manual.</p>

*Ensure that the fan is switched off from the supply mains before removing the guard.

Introduction to the Accessories

Product accessories

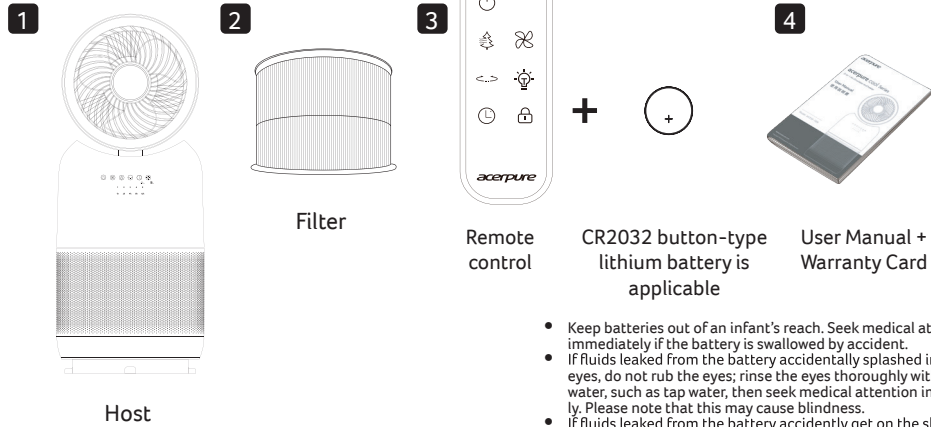

- Keep batteries out of an infant's reach. Seek medical attention immediately if the battery is swallowed by accident.
- If fluids leaked from the battery accidentally splashed into the eyes, do not rub the eyes; rinse the eyes thoroughly with clean water, such as tap water, then seek medical attention immediately. Please note that this may cause blindness.
- If fluids leaked from the battery accidentally get on the skin and clothes, please wash it off immediately with clean water. Please note that this may also cause dyeing.
- To discard batteries, please dispose of them according to the recycling methods of your living area (cover both the "+" and "-" sides of the battery with scotch tape when discarding).

Remote control battery installation

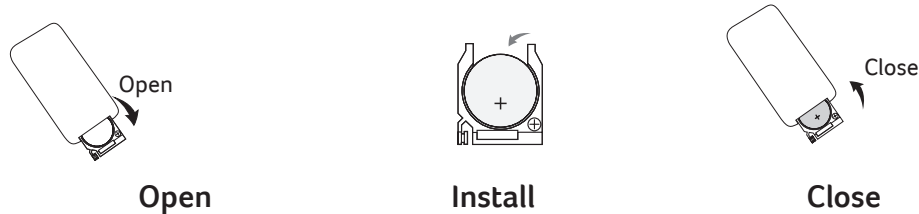

1. Press the button on the left lightly while pulling the battery cover downwards to remove the battery box cover.
2. Face the positive (+) side of the battery upwards.
3. Push the battery cover back to its original outlet and close it completely.

Remote control precautions

- The remote control must face the receiver directly (Face the remote control downwards and aim it at the operation panel for use).
- The usage range of the remote control is approximately within 500cm to the front of the receiver; if the remote control is not faced towards the receiver, its usage range will be reduced.
- Do not place any obstacles between the receiver and the remote control.
- Please keep the remote control properly; avoid impacts and dropping. Please remove the battery when not using the remote control, and keep it in a safe place.

Product Structure

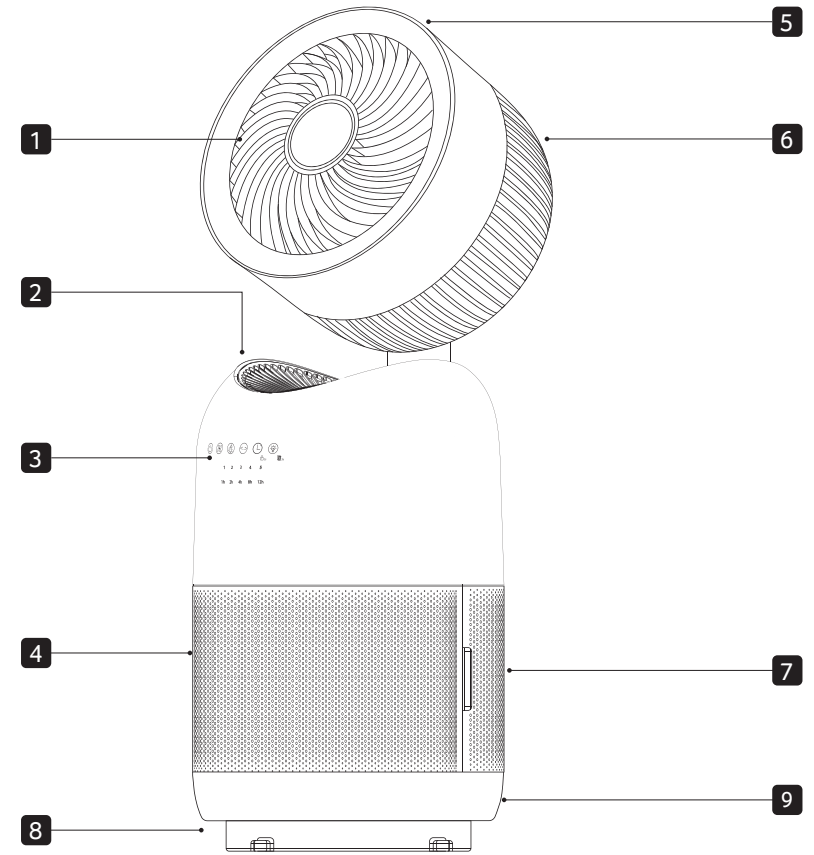

- 1 Front grill of the air circulator
- 2 Air outlet
- 3 Control panel
- 4 Air inlet
- 5 Remote control magnet
- 6 Rear grill of the air circulator
- 7 3-in-1 HEPA filter
- 8 Ambient light
- 9 Power switch

Function Buttons of the Product

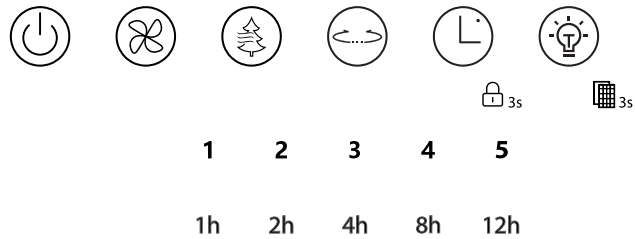

Power ON/OFF

You can start or stop using this product.

* Initial use of this product (After power is disconnected, each time power is reconnected is considered initial use)

Air circulator wind speed

The wind speed strength of this product is divided into 5 stages; you can adjust the wind speed strength of the air circulator of this product. When you press it the 6th time, the air circulator will be switched off.

Purifier wind speed

This product has a total of five stages of purifier wind speeds; you can adjust the purifying strength of this product according to your needs. When you press it the 6th time, the purifying function will be switched off.

Timed shutdown

You can preset the product to shutdown automatically after 1 hour, 2 hours, 4 hours, 8 hours, and 12 hours.

• Child lock function

Press and hold down the timed shutdown button for 3 seconds to enable child lock; press and hold it down for 3 seconds again to cancel child lock.

Left and right swing mode

It allows you to set the body of this product to swing left and right, pressing it for a second time will stop it from swinging.

Comfort light display

Allows you to turn on the sleep light function under the case of this product, press it a second time to switch off the light.

* When the filter of this product needs to be changed, the filter change indicator of this product will light up automatically; after replacing the filter, please press and hold down the comfort light button for 3 seconds to switch off the filter indicator.

Disassembling and Maintenance

Disassembly and assembly of the filter

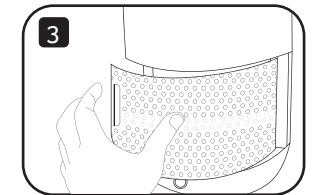
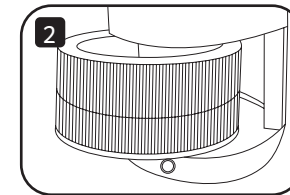
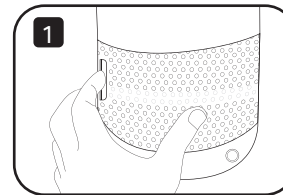

1. After switching off the power and unplugging the power plug, pull the handle on the filter cover behind the product backward.

2. Remove the filter and replace it with a new filter.

3. Place the filter cover back onto the product.

- * It is recommended to replace the filter every 3,000 hours.
- * When the filter indicator flashes, please remove the filter and replace or clean the filter based on the filter's cleanliness.
- * After installing the filter back into this product, press and hold down the power button and purifier wind speed button simultaneously for 3 seconds to switch off the filter replacement indicator.
- * Avoid tugging on the power cable during the disassembly process in order to prevent the power cable from breaking.
- * When using this product for the first time or replacing a new filter, please remove the packaging bag of the filter first and then start using this product.

Maintenance

This product only requires general external cleaning and maintenance (as shown in the figure).

- Do not wipe with thinner, toluene, acidic cleansers, lamp oil, alcohol, or chemical cloth in order to avoid discoloration or deterioration.

Please note: After maintenance and cleaning, wait for the product to fully dry before connecting power to use again or storing. If the product needs to be stored, please place the product back into the packaging box in the original packaging order, and place it at a dry location for safekeeping.

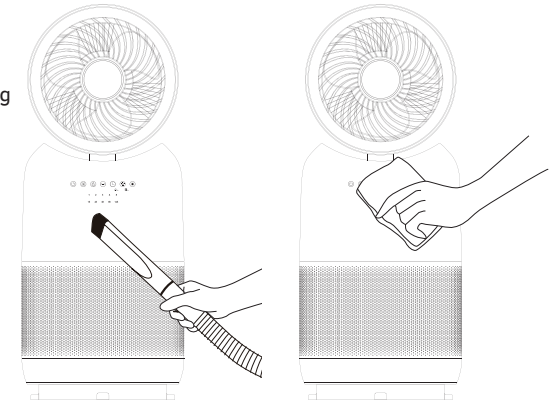

Use a vacuum cleaner to clean the dust in the air outlet and inlet.

Use a soft cloth to wipe the exterior and the sensor cover at the back of the product.

Battery Precautions

- Do not place the battery within a distance that infants and young children can reach. If you, or a child accidentally swallows the battery, please consult a doctor immediately.
- In the unlikely event that the liquid leaking from the battery sprays into your eyes, do not rub your eyes, and see a doctor immediately after washing with water. Please note that this may cause blindness.
- If the liquid leaked from the battery gets on your skin or clothing, please wash the affected area with water immediately. Please note that this may leave a stain on clothes.
- If you want to throw the battery away, please follow the garbage classification method in your area (please use transparent tape to wrap the "+" and "-" sides when discarding).
- Please do not attempt to recharge non-rechargeable batteries.
- Please do not mix different battery types, or new and used batteries.
- Please do not insert batteries with the incorrect polarity.
- Please safely dispose of exhausted batteries.
- If the appliance is to be stored unused for a long period of time, the batteries should be removed.
- Please do not short-circuit supply terminals.
- **WARNING:** Keep out of reach of children. Swallowing can lead to chemical burns, perforation of soft tissue, and death. Severe burns can occur within 2 h of ingestion. Seek medical attention immediately.



Before Seeking After-sales Service

If you discovered that the product malfunctioned, please check the following items before contacting customer service.

Problem	Possible cause	Solution
Product does not turn on	Is the power plug plugged in the outlet properly?	Please plug the power plug of this product in the outlet correctly.
	The power switch at the bottom behind the host is not turned on.	Please turn on the power switch at the bottom behind this product.
Buttons of the control panel have no responses	Is the child lock function enabled?	Please press and hold down the direction button for 3 seconds to disable the child lock function.
	Is there excessive dust or harmful	
	Are there other sundries around the product?	Please remove the sundries around the product.
When the noise is too loud	Is there excessive dust accumulated in the air circulator?	Please clean the grill of the air circulator properly.
	Is there excessive dust or harmful	
	Are there foreign objects stuck in the air circulator?	Please clean the foreign object from the air circulator grill.
	Is the product placed on an uneven	or table top.
When the remote control cannot be operated	Is the battery dead?	Please replace the battery (Applicable model of the remote control: CR2032).
	Was the remote control pointed towards the front of the product when used?	Please change the usage angle and point the remote control to the product when in use.
Stopped operating	Was the timer function set?	After the timer is set, when the set time has ended, it will stop operating automatically.
Will not stop operating even	When the "warm air function" is used, air will continue to be supplied for approximately 15 seconds to	It is not a malfunction.

Product specifications

Product specifications	
Product name	Air circulator and Purifier
Product model	AC333-10W
Rated voltage	220-240V 50/60Hz
	110 V/ 60Hz (only for models sold in Taiwan)
Rated power	27W
Net weight	5.04Kg
Product dimensions	253 x 253 x 550mm
Place of origin	China

Company information

acerpure

www.acerpure.com

Memo

acerpure